

Sonoma Arched Mantel
for Ceresa Gas Fireplace



Assembly / Installation Guide

PLEASE READ

These instructions apply only to the cabinetry and facing material that will surround the firebox. **PLEASE SEE THE FIRE-PLACE MANUFACTURER'S INSTALLATION INSTRUCTIONS TO ENSURE THAT ALL CLEARANCE AND INSTALLATION REQUIREMENTS ARE BEING MET.**

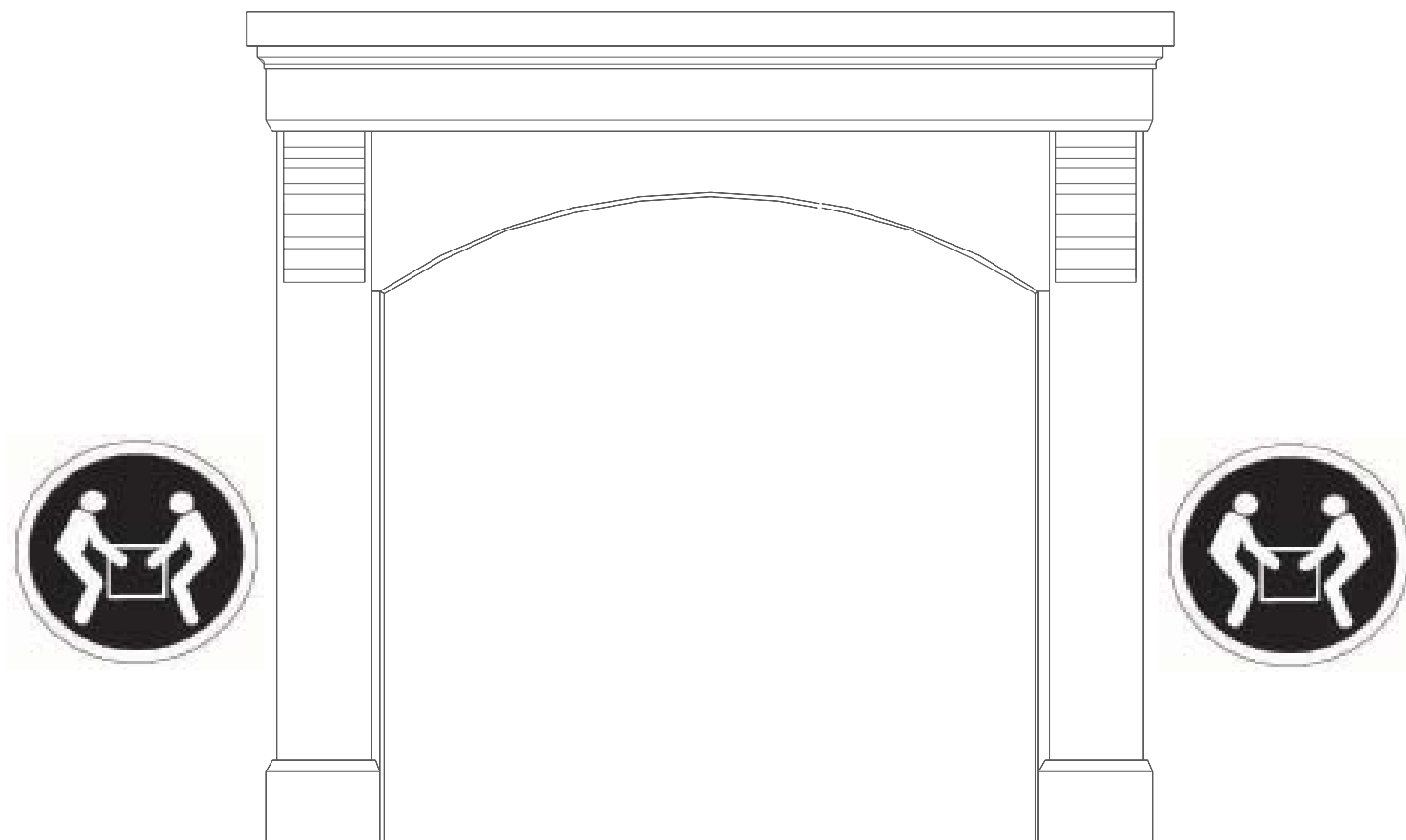

Notice !!

For field finishing the following two products have been approved for use on this product:

1. Lacquer - Sherwin Williams "Wood Classics A68F90".
2. Paint - Sherwin Williams "Duration Home A98W151 Interior Latex Paint".

All other products may result in discoloration or undesired results.

CALL US FIRST

DO NOT RETURN TO THE STORE

For immediate help with assembly, or for additional product information, call our toll-free number:

1.888.880.0192

Warning !!

- Improper installation, adjustment, can cause injury or property damage. For assistance or additional information, consult a qualified installer, service agency, or the gas supplier.
- Comply with all minimum clearances to combustibles as specified in firebox manual. Failure to comply may cause house fire.
- If this mantel is made from Knotty Alder, pre-drill inside scribe pieces to avoid splitting.

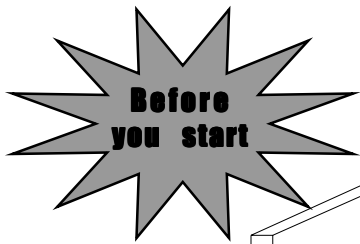

The walls and floor in the area of the installation should be clean, plumb and level. Any major deviation should be remedied before installing the fireplace, marble or the mantel /cabinet.

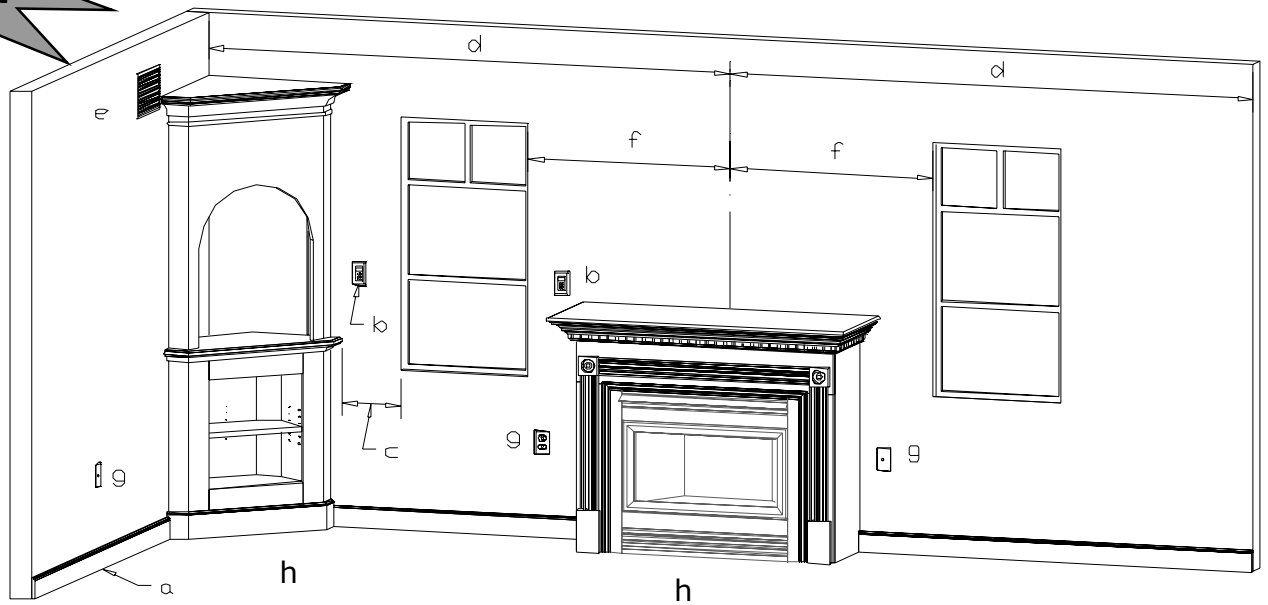

Above is a diagram of issues that may prevent an installation of wood products around a firebox:

- a. Is base molding already installed?
- b. Where are the electrical outlets or firebox switch?
- c. Is there enough distance between windows and edge of cabinet?
- d. Is the fireplace centered between walls?
- e. Return air vent location?
- f. Is the fireplace centered between windows?
- g. Where are the electrical & cable outlets positioned?
- h. Is there hardwood or carpet going in?

Parts List and Diagram

MANTEL PARTS:

- | | |
|------------------------|-----|
| 1 Mantel Top | (a) |
| 1 Ledger Board | (b) |
| 1 Breastboard Assembly | (c) |
| 2 Legs | (d) |
| 3 Scribe | (e) |

Hardware Kit Includes:

- 14 1.5" Drywall Screws
- 4 3" Drywall Screws

Tools and supplies needed:

- #2 Phillips Screwdriver
- High Temperature Silicone Caulk
- Finishing Nails & Hammer

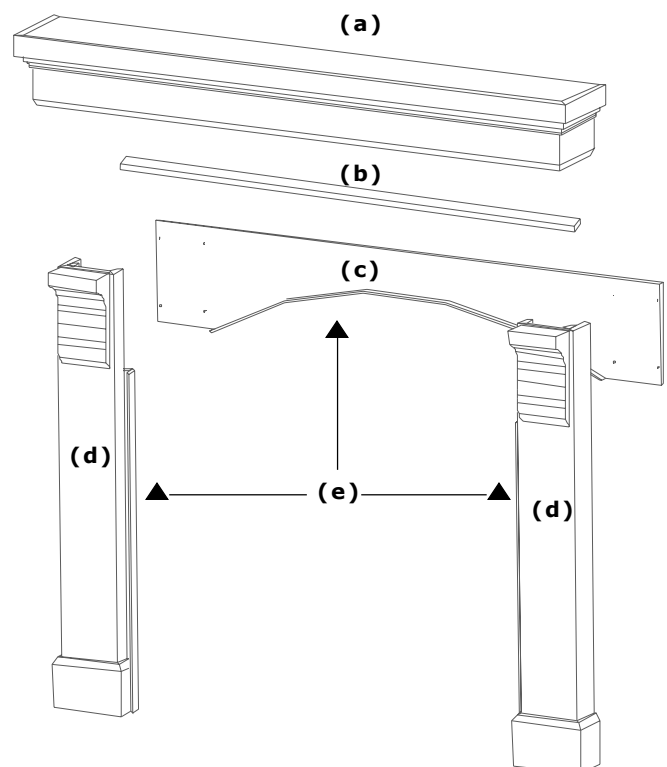

Assembly steps

1.

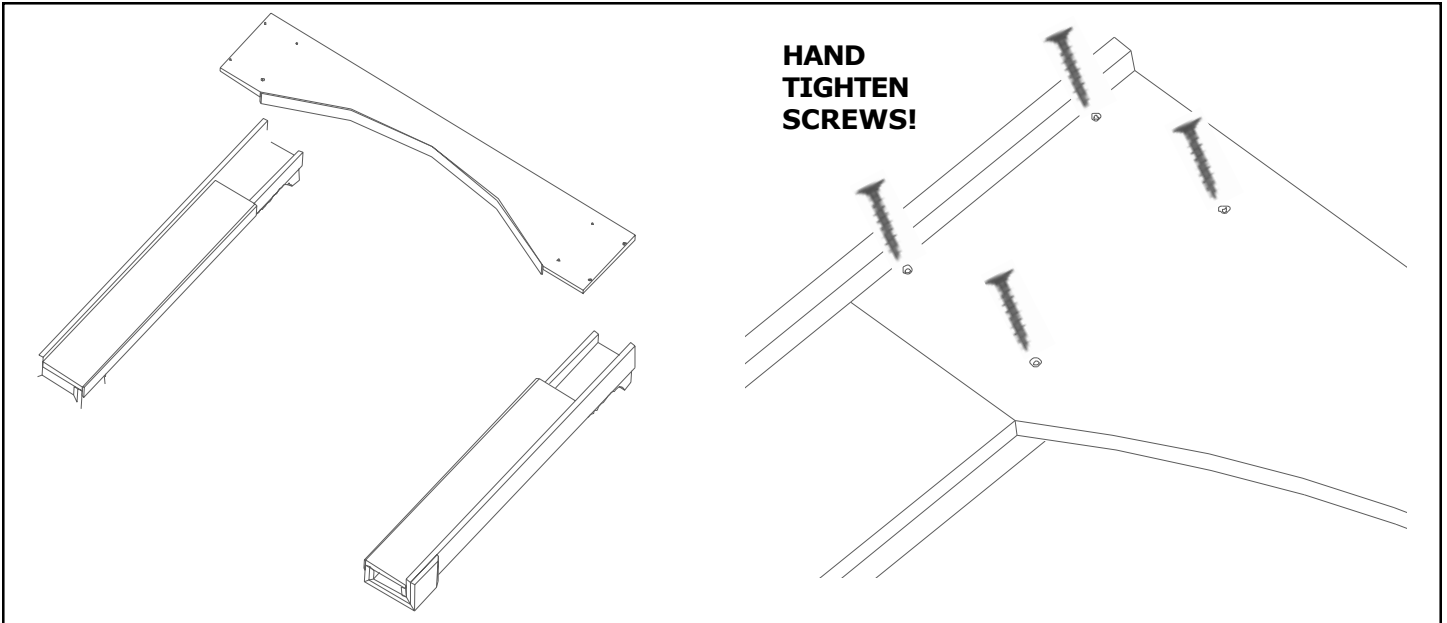

2.

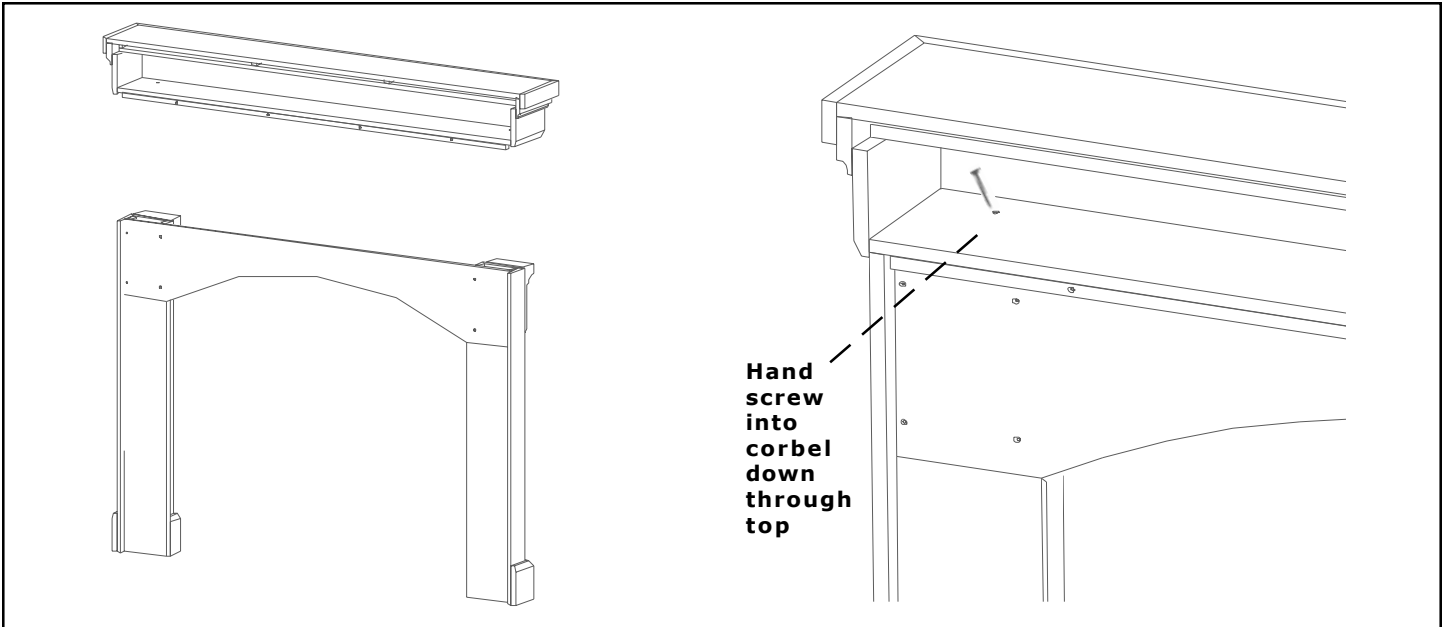

CAUTION!! IT IS RECOMENDED THAT (2) PEOPLE ASSEMBLE THIS MANTEL DUE TO ITS WEIGHT, AND UPRIGHT POSITIONING.

1. Position mantel legs laying flat on a clean floor. Attach the breastboard assembly to the legs using (8) 1.25" drywall screws. Make sure the seams and edges are tight and square. Stand attached assembly up. (See figure #1)
2. Have someone hold the breastboard & legs from the front of the mantel. Standing behind the breastboard, attach the top using (6) 1.25" drywall screws. (See figures 2 & 3)

Assembly steps

3.

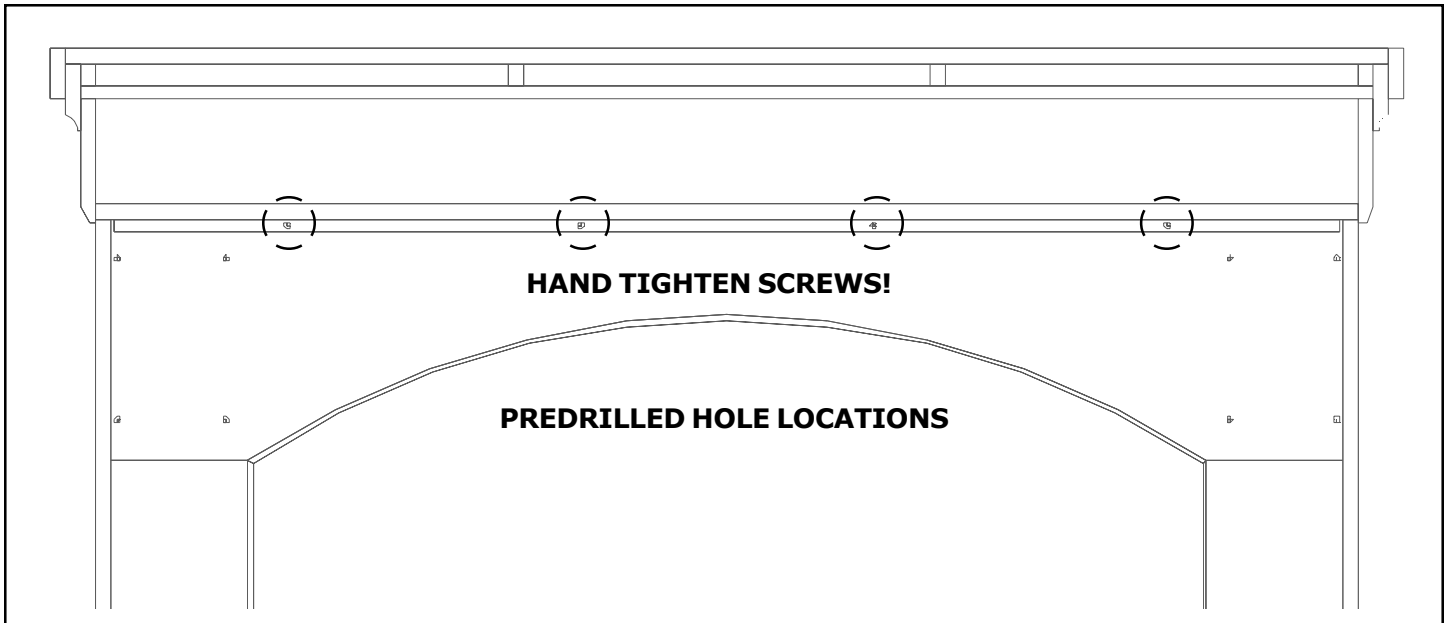

4.

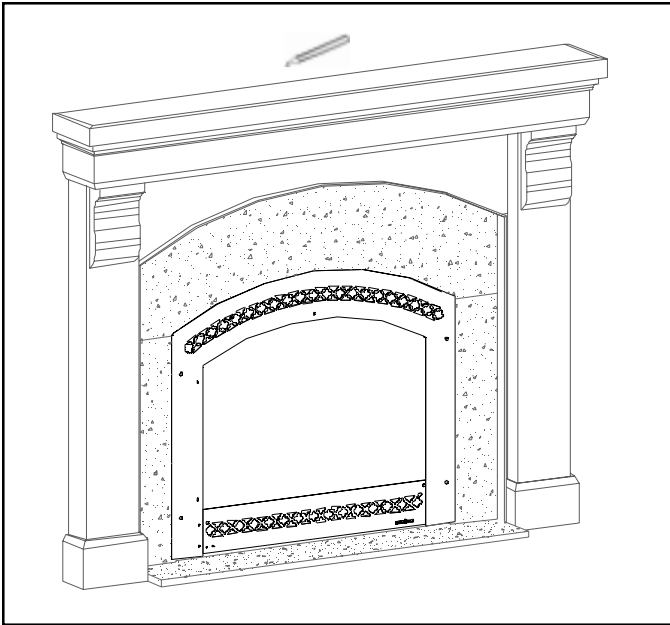

5.

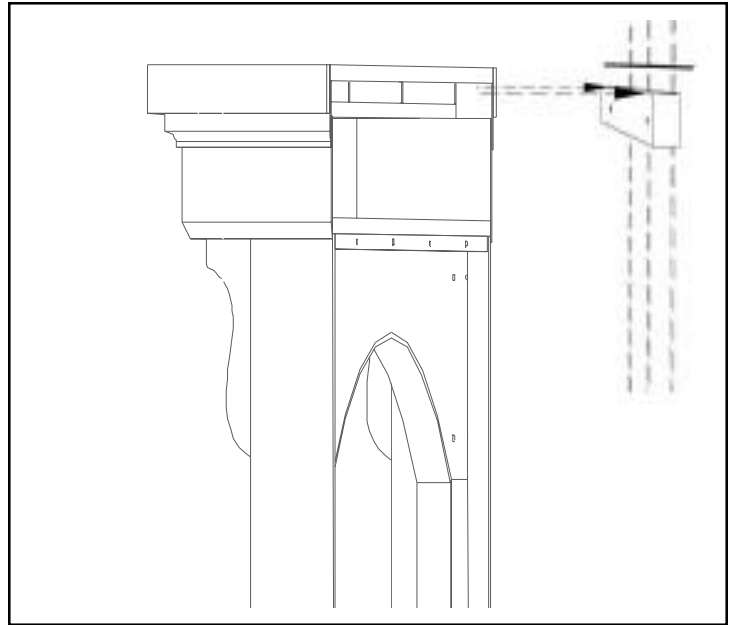

3. Position and center the mantel over the fireplace. Using a sharp pencil, draw a line across the back edge of the mantel top. Carefully remove the mantel. (See figure #4)
4. Measuring down from the first line the thickness of the mantel top, mark two points and draw a second line. This line positions the top of the ledger board. (See figure #5)
5. Using a stud finder or other method, mark off the location of the vertical studs below the two horizontal lines. From the center of the fireplace, mark off the center point in which the ledger board needs to be mounted. Attach the ledger board using (4) 3" inch drywall screws provided into pre-marked stud locations. **If the ledger board is not centered above the fireplace it WILL NOT fit behind the mantel.** (See figure #6)

Assembly steps

6.

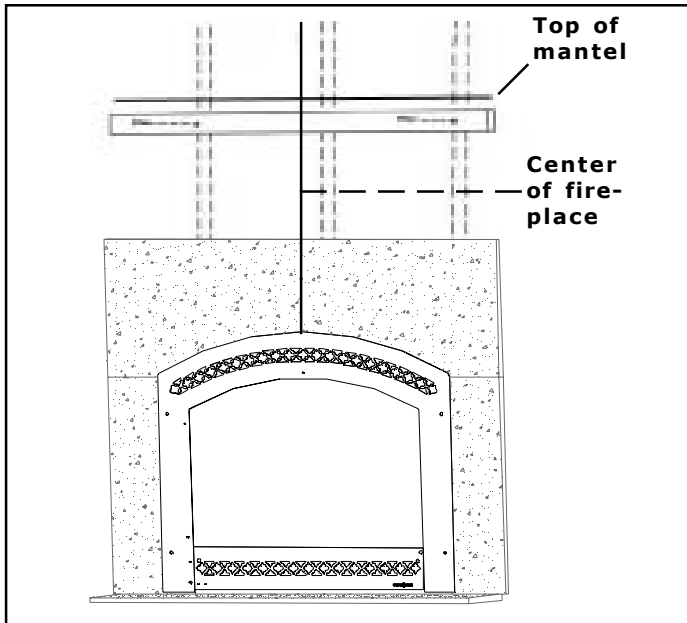

7.

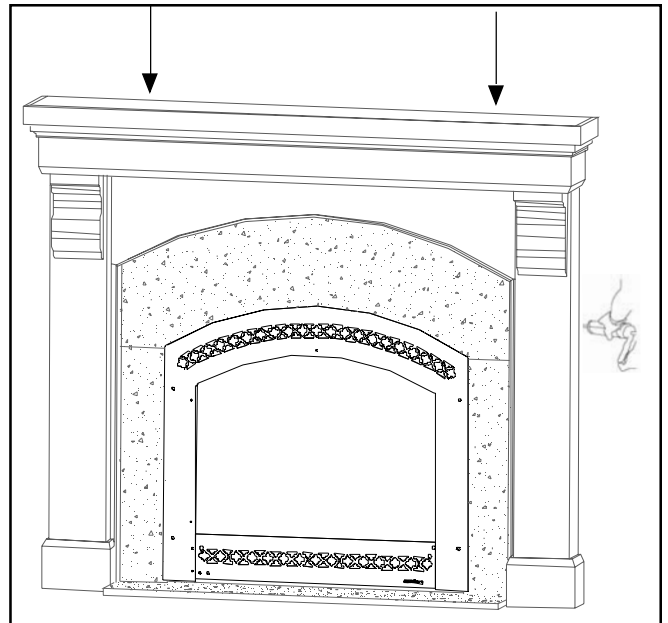

8.

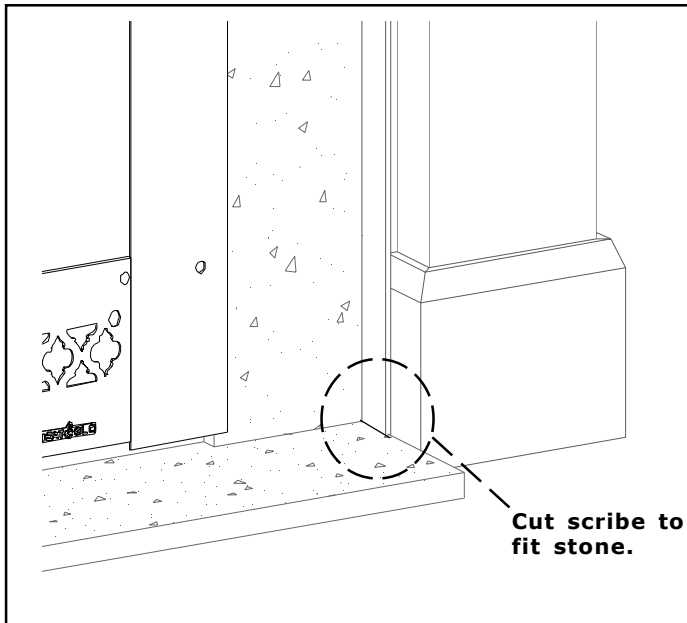

9.

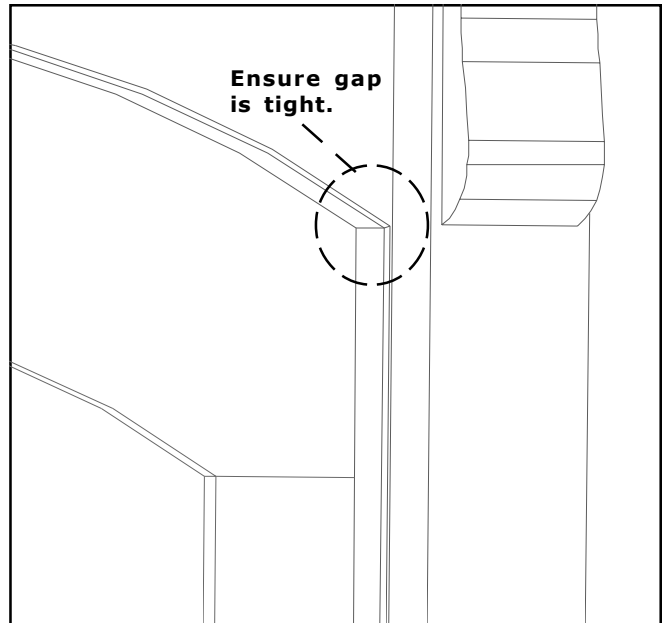

CAUTION: KNOTTY ALDER IS A HARD WOOD AND PRONE TO SPLITTING. IF THIS MANTEL IS MADE FROM KNOTTY ALDER IT IS RECOMMENDED TO PRE-DRILL THE INSIDE SCRIBE PIECES PRIOR TO ATTACHING THEM TO THE MANTEL TO AVOID SPLITTING.

6. Center and place mantel on wall overlapping the non-combustible facing material with the top resting on the ledger strip. Using an electric drill, pre-drill holes down through the top into the ledger strip. The holes should be drilled 1" off of the back edge of the top. Attach the mantel to the ledger board using nails through pre-drilled holes (Nails not included). Caulk sides of mantel if needed with silicone. (See figure #7)
7. Cut the leg scribe 3/4" to allow for stone height between the legs. Place the scribe molding as shown above, positioning it so that it just contacts the non-combustible surround. Be careful not to hit the facing material when nailing the scribe in place. (See figure #8, #9)



HEAT & GLO, a brand of Hearth & Home Technologies, Inc.
20802 Kensington Boulevard, Lakeville, MN 55044
www.fireplaces.com

Please contact your HEAT & GLO dealer with any questions or concerns. For the number of your nearest HEAT & GLO dealer, please call 1-888-427-3973.

-Notes-

CAUTION

DO NOT DISCARD THIS MANUAL



- Important operating and maintenance instructions included.
- Read, understand and follow these instructions for safe installation and operation.
- Leave this manual with party responsible for use and operation.

